

STANDARD MANIFOLD LINE MOUNT BODIES

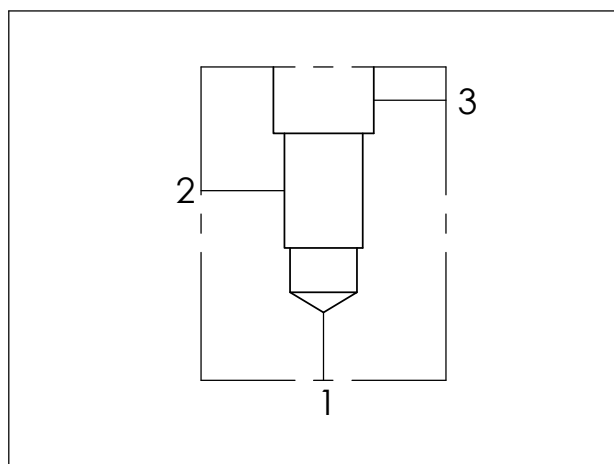
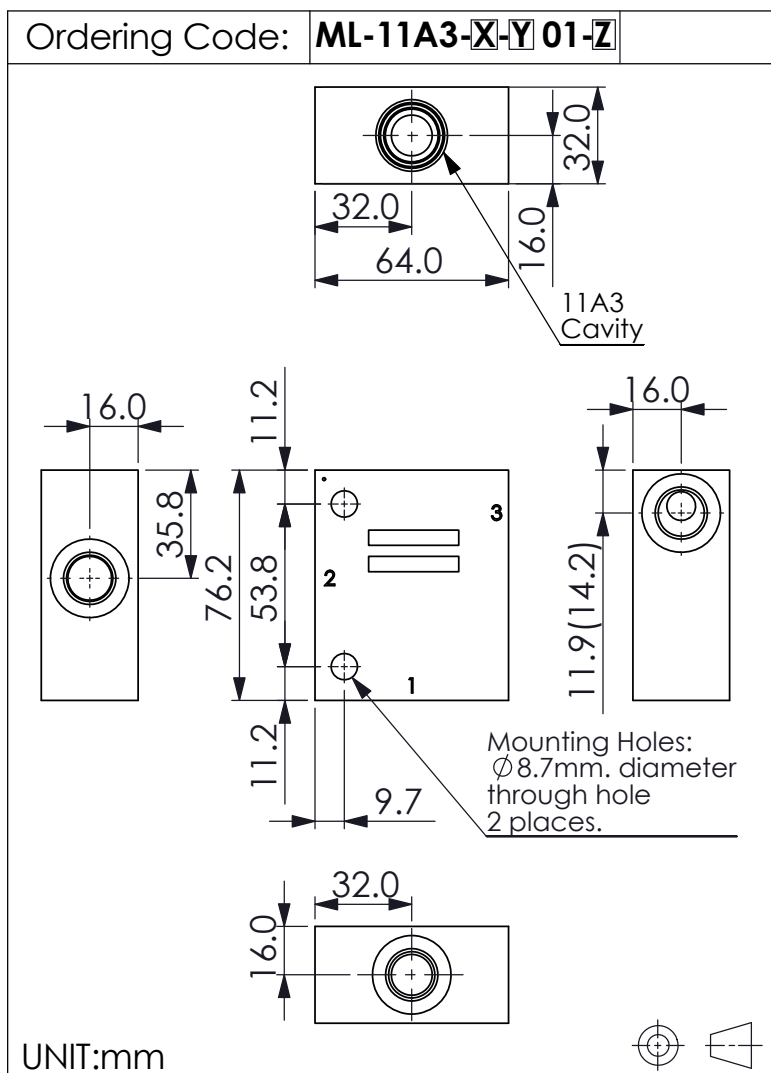

TECHNICAL DATA

Aluminum Body Pressure Rating: 210 bar
Ductile Iron Body Pressure Rating: 350 bar

Cavity:

Refer to 11A3

* Refer to Winner Cartridge Valves Catalog.

Aluminum	0.35 kg(WITHOUT VALVES)
Ductile Iron	0.95 kg(WITHOUT VALVES)
Steel	

* If you need the special specification. Please contact us.

X	PORT SIZE		
	PORTS	PORT	
	1,2	3	
G02	G 1/4"	G 1/4"	
G03	G 3/8"	G 3/8"	
G03A	G 3/8"	G 1/4"	
G04A	G 1/2"	G 1/4"	
G04B	G 1/2"	G 3/8"	
P03	3/8"PT	3/8"PT	
S06	SAE 6	SAE 6	
S08A	SAE 8	SAE 6	
S10A	SAE 10	SAE 6	

Y	BODY MATERIAL	
A	HIGH-STRENGTH ALUMINUM	
S	DUCTILE IRON	

Z	CARTRIDGE VALVES SELECTION	
	WITHOUT VALVE	
RV0A	RV11A30AL (60LPM,7-210bar)	
CB3H	CB11A33HL (60LPM,70-280bar)	
CO20	CO11A3020N (60LPM,2.0bar)	
CC20	CC11A3020N (60LPM,2.0bar)	
SP0A	SP11A30AL (60LPM,7-210bar)	

The selection is only example. Please refer to Winner Cartridge Program and to select the appropriate valves and manifolds assembly in accordance with request function (flow 、 pressure 、 ... etc.)